

EN | DE | FR | ES | IT | JP

 Mobvoi Home

Product Instruction Manual

TREADMILL PLUS

Model NO:T4225

 Mobvoi Home

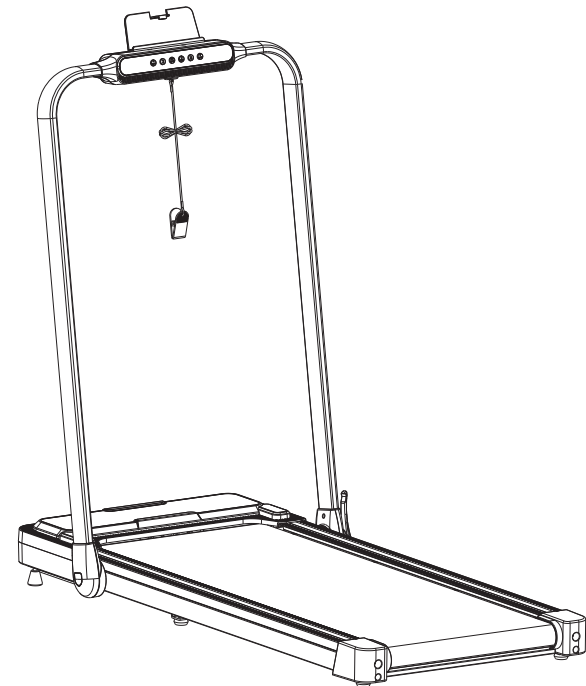

Please read the instruction carefully before using.

Table of contents

1. Safety Precautions & Warning Instructions -----	02
2. Product Introduction-----	06
3. Setup Instructions-----	08
4. Adjustment of the Folding Handle Tension -----	10
5. Exercise Recommendations and Guidelines -----	11
6. Operation Instructions -----	13
7. Common Malfunctions And Troubleshooting -----	17
8. Product Maintenance -----	18
9. Service Commitment-----	19
10. FCC Statement-----	20

1. Safety Precautions and Warning Instructions

Note: Please read the instruction manual carefully before use and pay attention to the following safety precautions.

- ★ The treadmill should be placed in a well-ventilated and dry indoor area to avoid moisture. Do not place any foreign objects on the treadmill to prevent motor damage due to water entering the motor.
- ★ Before starting exercise, ensure you are wearing appropriate sportswear and professional sports shoes, and perform full-body stretching activities. Do not exercise barefoot on the treadmill.
- ★ The power plug must be securely grounded, and the socket used should have a dedicated circuit to avoid sharing power with other electrical devices.
- ★ Keep children away from this equipment to prevent accidents.
- ★ Avoid prolonged operation of the treadmill under overload conditions, as this may lead to damage to the motor and controller, accelerating wear and aging of bearings, running belts, and the deck. Regular maintenance is recommended to ensure the equipment is in good condition.
- ★ To maintain the normal operation of electronic instruments and controllers, reduce indoor dust, and maintain appropriate indoor humidity to prevent strong electrostatic interference.
- ★ After use, be sure to turn off the power of the treadmill.
- ★ Maintain indoor air circulation while using the treadmill.
- ★ If you feel discomfort or experience abnormal conditions during exercise, stop immediately and consult a medical professional.
- ★ After using silicone oil, store it in a place inaccessible to children to avoid serious consequences in case of accidental ingestion.
- ★ The safety area behind the treadmill is 39.37*78.74inch.
- ★ The method to jump off the treadmill in an emergency is: grasp the handrails with both hands, lift the body, and simultaneously place both feet on the side strips, then jump off the treadmill from one side.
- ★ Avoid placing the treadmill on a carpet, as this may reduce ventilation and cooling efficiency, leading to potential motor burnt out.
- ★ Do not place the treadmill on uneven floors, as this may cause imbalance during use and damage the treadmill.

Warning: To reduce accidents, please follow these regulations.

- ★ Before using the treadmill, check if clothing is properly fastened or zipped up.
- ★ Avoid wearing items that may be caught by the treadmill.
- ★ Keep the power cord away from heat sources.
- ★ Prevent children from approaching the treadmill.
- ★ Do not use the treadmill outdoors.
- ★ Disconnect the power before moving the treadmill.
- ★ Do not open the upper cover and left and right rear seats without professional supervise.
- ★ Restricted to one person exercising on the treadmill.
- ★ If you feel dizziness, chest pain, nausea, or shortness of breath during exercise, stop immediately and consult a medical professional.

Warning! Mandatory!

When you are undergoing medical treatment or belong to the following patient types, be sure to consult a professional doctor before using.

- (1) Patients experiencing lower back pain or those who have suffered injuries to the legs, lower back, or neck, or those experiencing pain in the legs, lower back, neck, and arms (such as chronic patients with disc herniation, spinal slippage, cervical protrusion, etc.).
 - (2) Patients with osteoarthritis, rheumatism, or painful rheumatism.
 - (3) Individuals with abnormalities such as osteoporosis.
 - (4) Individuals with circulatory system diseases (heart disease, vascular disease, high blood pressure, etc.).
 - (5) Individuals with respiratory organ disorders.
 - (6) Individuals using artificial pacemakers or implanted medical electronic devices.
 - (7) Individuals with malignant tumors.
 - (8) Individuals with thrombosis or severe blood circulation disorders, acute venous inflammation, etc.
 - (9) Individuals with peripheral circulation disorders caused by conditions such as diabetes.
 - (10) Individuals with skin wounds.
 - (11) Individuals with fever due to diseases (skin temperature reaching 38°C or above).
 - (12) Individuals with abnormal or bent backs.
 - (13) Pregnant or potentially pregnant women, or women in menstruation.
 - (14) Individuals feeling physically abnormal and in need of rest.
 - (15) Individuals with obvious poor physical condition.
 - (16) Individuals using the equipment for rehabilitation purposes.
 - (17) Individuals who feel any abnormality in their body other than the above situations.
- Use may cause accidents or worsening of physical condition.

- ◆ If you experience unusual pain, such as lower back pain, leg numbness, dizziness, abnormal heartbeat, or a sense of discomfort different from usual during exercise, stop immediately and consult a medical professional.
- ◆ Do not allow children to use this product or play around it.
- Non-compliance with this regulation may lead to injury.
- ◆ Supervisors of children should be careful not to let them play with this product.
- Non-compliance with this regulation may result in injury.
- ◆ During use or when loading and unloading the product, ensure that there are no people or pets around (rear, bottom, front of the product).

Prohibited!

- ◆ Do not use this device if the housing is cracked, broken, or detached (exposing internal structures) or if welded parts are detached.
- Otherwise, accidents or injuries may occur.
- ◆ Do not jump on or off the treadmill during exercise.
- Doing so may cause falls and injuries.
- ◆ Do not use or store the treadmill outdoors, in the bathroom, or in damp or easily wet places.
- ◆ Do not place the treadmill in direct sunlight or in a high-temperature environment, such as around a fireplace or on heating devices such as electric blankets.
- Otherwise, electrical leakage or fire may occur.

- ◆ If the power cord or power plug is damaged or the socket is loose, do not use the treadmill.
- Otherwise, electric shock, short circuit, or fire may occur.
- ◆ Do not damage, bend, or twist the power cord. Also, avoid placing heavy objects on the power cord or pinching the wire.
- Otherwise, leakage or fire may occur, or even electric shock, short circuit.
- ◆ Do not let two or more people use the treadmill simultaneously, and be mindful of the absence of others around during use.
- Otherwise, accidents or injuries may occur.
- ◆ Do not allow individuals who cannot express their consciousness or operate the treadmill independently to use it.
- This may result in accidents or injuries.

Do not disassemble the treadmill!

- ◆ Absolutely prohibited to disassemble, repair the walking treadmill, or replace the treadmill's components.
- There is a risk of injury due to mechanical failure.

Avoid contact with water!

- ◆ Do not allow the main body or control components to come into contact with water or other conductive liquids.
- This may result in electric shock or fire.

Prohibited!

- ◆ People who do not exercise regularly should not engage in strenuous exercise suddenly.
- This may cause harm to health.
- ◆ Do not use after drinking water, feeling fatigued, during the early stages of exercise, or when the body is in an abnormal condition.
- This may lead to injury.
- ◆ This product is suitable for home use and is not suitable for places with multiple non-specific users, such as schools or gyms.
- ◆ Do not use during drinking, eating, or other activities.
- ◆ Do not use when feeling sluggish after drinking.
- This may cause accidents or injuries.
- ◆ Do not use with hard objects in the pockets of pants.
- ◆ This may cause accidents or injuries.
- ◆ Do not allow needles, garbage, or water to attach to the power plug.
- This may cause electric shock, short circuit, or fire.
- ◆ Do not pull out the power plug or switch the power switch to "off" during use.
- This may cause injury.

Caution with wet hands!

- ◆ Do not pull out or insert the power plug with wet hands.
- This may cause electric shock and injury.

Pull out the power plug!

- ◆ When the equipment is not in use, pull out the power plug from the socket.
- Dust and humid air may cause insulation degradation, leading to electrical leakage or fire.
- ◆ When maintaining, be sure to pull out the power plug from the socket.
- Non-compliance may result in electric shock or injury.
- ◆ When the equipment cannot start or abnormalities occur, stop using it. Immediately pull out the power plug, and entrust a professional to inspect and repair.
- Non-compliance may result in electric shock or injury.
- ◆ During a power outage, pull out the power plug immediately.
- Otherwise, there may be accidents or injuries when power is restored.
- ◆ When pulling out the power plug, do not pull the wire portion; grip the plug to pull it out.
- Otherwise, short circuits, electric shock, or fire may occur.

Grounding instructions!

- ◆ This product requires grounding. If the equipment malfunctions, grounding will provide the minimum resistance path for current, reducing the risk of electric shock.
- ◆ The product is equipped with a wire for grounding the device and a grounding plug. This plug must be inserted into a properly installed and grounded socket that fully complies with local regulations or legal requirements.

Danger!

- ◆ Improper connection of the grounding conductor of the device may result in an electric shock hazard. If you have any doubts about the grounding of the product, please entrust a professional electrician for inspection. Even if the plug provided with the equipment does not match the socket, do not modify it.
- Please have a professional electrician install the appropriate socket.
- ◆ This product has a grounding plug. Ensure it is connected to a socket that matches its plug shape.
- This product cannot be plugged to an adapter.

2. Product Introduction

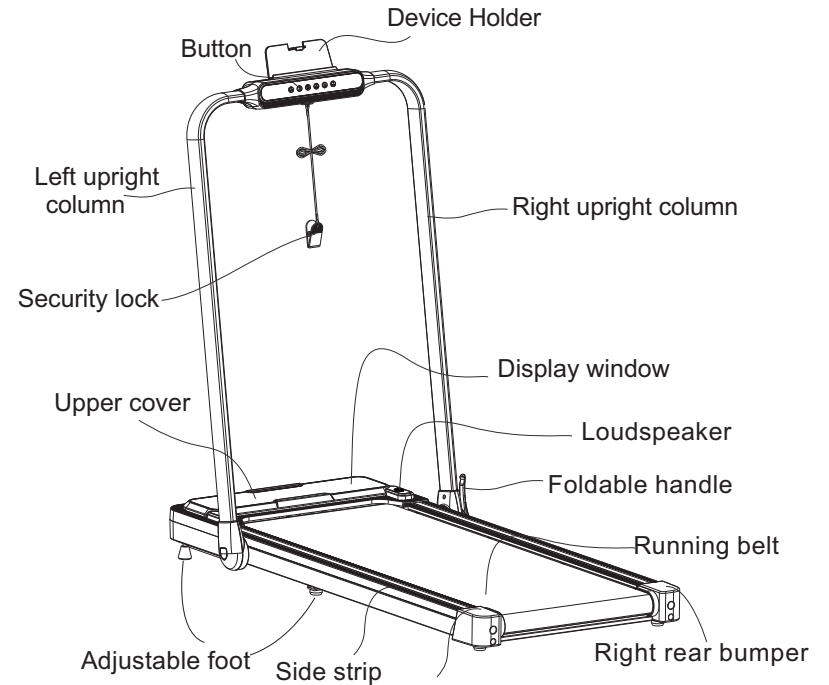

Packing List:

NO.	Name	Qty.	Remarks
1	Main Unit	1	
2	Spare Parts Package	1	See attached table

Technical Parameters

Working Voltage	AC 110V 60Hz
Maximum Load	265LBS
Product Dimensions	48.78"x25.27"x44.33"
Folded Dimensions	54.3"x25.27"x4.68"
Running Area	16.5"x40.16"
Maximum Power	2.5HP
Displayed Speed	0.6-7.6mph
Control Method	Remote control, electronic display

Attachment (Spare Parts Package List)

NO.	Name	Qty.	Remarks
1	Cross Recess Countersunk Self-tapping Screw	2	Fixed Device Holder
2	5# Inner Hexagonal Wrench	1	Miscellaneous
3	6# Inner Hexagonal Wrench	1	Adjustment of Running Belt
4	Dull Wrench	1	
5	Socket Wrench	1	
6	Device Holder	1	
7	Remote Control	1	
8	Safety Lock	1	
9	Methyl Silicone Oil	1	
10	Instruction Manual, Certification	1	
11	Power Cord	1	

08 Setup Instructions

3. Setup Instructions

1. Place the main unit on the floor after unpacking, as shown in step (A) in the figure below. Break the "foldable handle" in the direction shown, and the lower end of the column will naturally open to both sides.

In step (B) below, lift the column up to the upper limit position.

In step (C) below, press down on the "foldable handle" to lock the column.

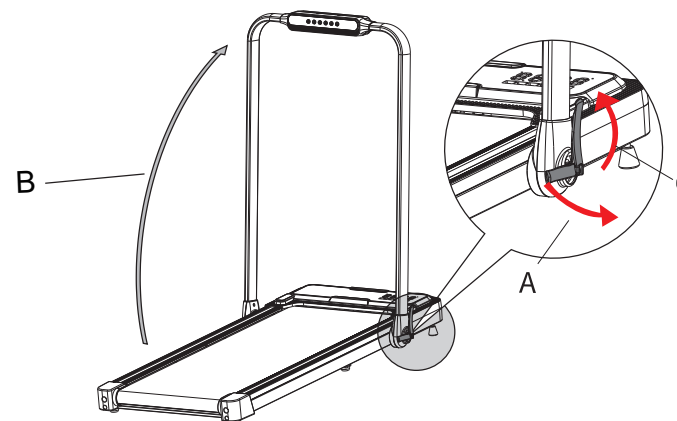

2. As shown in step (D) in the following figure, use a 5# inner hexagonal wrench to secure two ST4.2*16 cross recess countersunk self-tapping screws to fix the phone bracket on top of the console. The red safety lock (E) should be magnetized to the yellow position under the control panel. When using the treadmill, clip one end of the safety lock to the edge of your clothing.

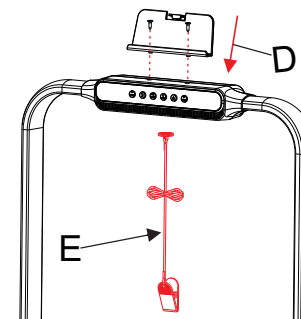

3. As shown below, insert the power cord into the front socket of the treadmill, then plug the power cord into the appropriate socket. Turn on the power switch at the bottom front of the machine, and the treadmill enters standby mode.

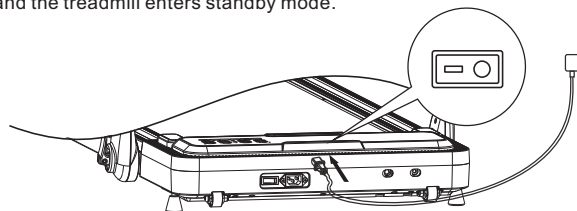

4. If the ground is uneven or the treadmill shakes, adjust the adjustable foot pads on the bottom middle and rear of the treadmill to the appropriate position. The foot pads must be close to the ground. (As shown below)

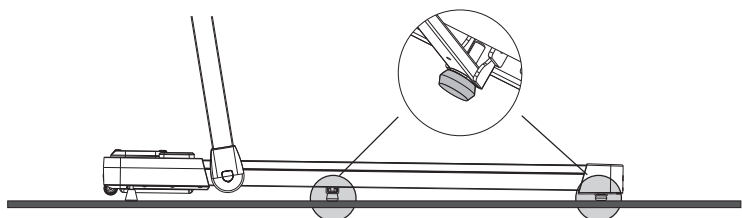

Folding and Moving the Treadmill

1. As shown in step (F) below, pry open the "folding handle" in the direction indicated in the diagram. At this point, the lower end of the upright column will naturally spread open to both sides.

In the direction shown in step (G) below, slowly lower the upright column down to the folding limit point.

In the direction shown in step (H) below, press down on the "folding handle" to lock the upright column.

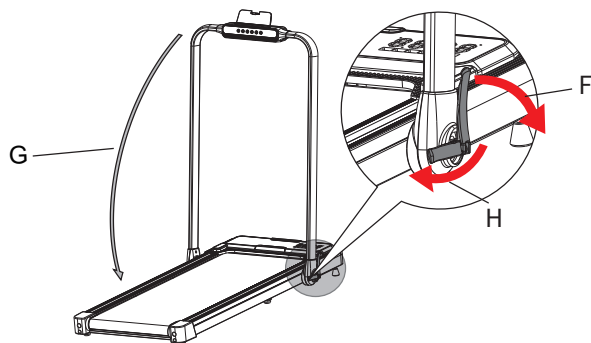

10 Adjustment of the Folding Handle Tension

2. To move the treadmill, follow the previous steps to fold the upright column. Before moving, always unplug the treadmill power cord. Then, lift the rear of the treadmill with your hands so that the moving wheels touch the ground and the front two footpads are lifted off the ground. This allows you to move the treadmill forward or backward.

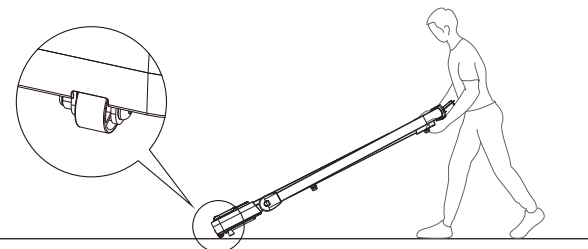

4. Adjustment of the Folding Handle Tension

The machine is shipped with this part adjusted to a slightly appropriate tension, but due to the difference of individual wrist strength, users can adjust the folding handle according to their preferences. Avoid loosening too much, as excessive loosening will cause treadmill shaking due to excessive clearance between the folding part of the column and the main unit. As shown in step ① in the figure below, pry out the plug at the lower end of the left column; combine the hexagonal socket wrench and socket wrench into a lever. Then as shown in step ② below, Insert the hexagonal head end of the socket wrench into the hole at the lower end of the left column and match it with the hexagonal screw, rotate clockwise to tighten, and counterclockwise to slightly loosen.

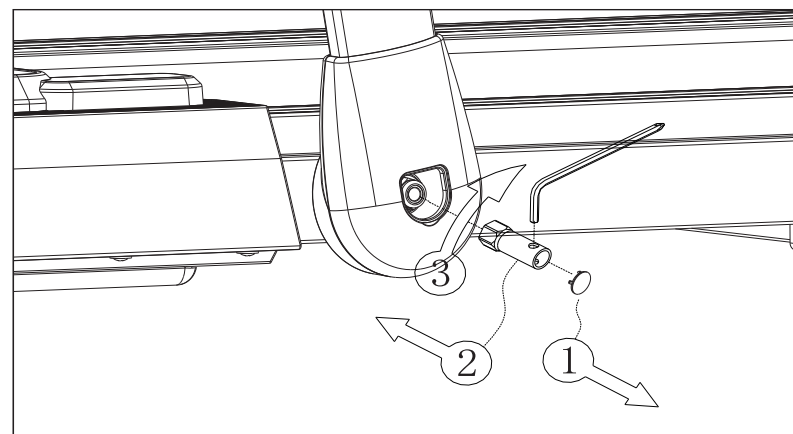

5. Exercise Recommendations and Guidelines

Warm-up

Before each session, a 5-10 minute warm-up is necessary.

Breathing

During exercise, do not hold your breath. Breathe regularly, coordinating with your movements. If breathing becomes too rapid, stop exercising immediately.

Frequency

Training the same muscle group should have a 48-hour rest period, meaning the same muscle group should not be trained on consecutive days.

Training Load

Determine the training load based on personal fitness level, then practice following the principle of progressive load. Muscle soreness is normal in the initial training. With consistent exercise, soreness will gradually subside.

Relaxation

Perform a 5-minute cool-down after each training session, especially stretching and relaxing the muscles in the feet to prevent prolonged tension and maintain muscle elasticity.

Diet and Hydration

It is recommended to exercise at least one hour after a meal, and avoid consuming food immediately after exercise. Drink water sparingly during exercise, especially avoiding large quantities to prevent stress on the heart and kidneys.

12 Exercise Recommendations and Guidelines

Stretching Exercises

It's advisable to start with stretching exercises before using the walking treadmill. Warmed up muscles are more flexible, so spend 5-10 minutes warming up. Before walking, perform the following stretching exercises – 5 times, 10 seconds or more for each leg; repeat this exercise after walking on the walking treadmill.

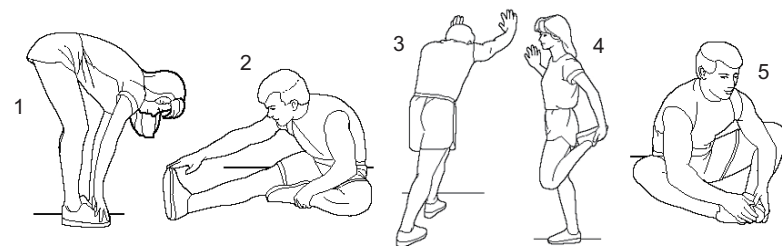

1. Forward Stretch

Bend both knees slightly, lean forward slowly, allowing the back and shoulders to relax. Try to touch your toes with your hands. Hold for 10-15 seconds, then relax. Repeat 3 times (see Figure 1).

2. Achilles Tendon Stretch

Sit on a clean mat with one leg straight. Bring the other leg inward, pressing it against the inner side of the straight leg. Try to touch your toes with your hands. Hold for 10-15 seconds, then relax. Repeat 3 times for each leg (see Figure 2).

3. Calf and Heel Tendon Stretch

Stand with both hands against the wall, with one foot at the back. Keep the back leg straight and the heel on the ground, lean towards the wall. Hold for 10-15 seconds, then relax. Repeat 3 times for each leg (see Figure 3).

4. Quadriceps Stretch

Hold onto the wall or table for balance with the left hand, then extend the right hand backward, grabbing the right ankle and slowly pulling it towards the buttocks until you feel tension in the front of the thigh. Hold for 10-15 seconds, then relax. Repeat 3 times for each leg (see Figure 4).

5. Adductor (Inner Thigh Muscles) Stretch

Feet facing each other, knees outward. Squat down, grabbing both feet and pulling towards the groin. Hold for 10-15 seconds, then relax. Repeat 3 times (see Figure 5).

6. Operation Instructions

Display

The display shows the countdown when starting, displaying "3", "2", "1". During operation, it automatically switches every 5 seconds to different display sections (in sequence: "SPEED", "TIME", "DIST" and "CAL").

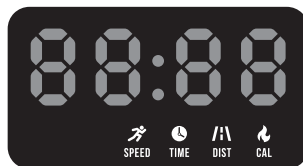

- During operation, the LED display automatically switches to display these metrics every 5 seconds.
- In standby state, when there is no operation, the display will be in sleep after 10 minutes, and can be woken up by key, remote control and security lock.

Display Metrics Ranges

Setting Parameters	Initial Value	Display Range
Time (min:sec)	0:00	0:00-99:59
Speed (mph)	0.6	0.6-7.6
Distance (miles)	0.00	0.00-99.99
Calories (kcal)	0.0	0.0-9999

Remote Control Pairing Method

When the safety lock is in the detached state, press and hold the "I>" button on the remote control. When you hear continuous beeping sounds from the treadmill buzzer, it indicates successful pairing. You can then start using the remote control to operate the treadmill. Once paired, subsequent usage does not require re-pairing.

Bluetooth Audio Connection

- While in standby mode, open the Bluetooth settings on your phone and search for the treadmill's Bluetooth audio name "Mobvoi TMP". Then, press and hold the "-" button on the remote control or the "-" button on the console. Your phone will display the corresponding Bluetooth name of the treadmill. Click the name to connect.
- After the Bluetooth audio is connected, while in standby mode, press and hold the "-" button on the remote control or the "-" button on the console to disconnect the Bluetooth audio.

Remote Control Functions

- Start/Stop:** In standby mode, press the "Start/Stop" button on the remote control. The treadmill will start a 3-second countdown and operate at a speed of 0.6mph. During exercise, you can press the "Start/Stop" button at any time to stop the motor.

14 Operation Instructions

- While the treadmill is running, a short press on the "+" button on the remote control will gradually increase the speed. A long press will increase the speed rapidly. The speed will continuously increase with an increment of 0.2mph.

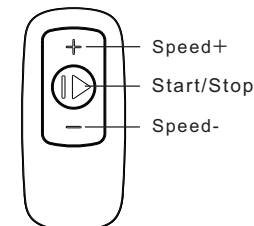

- While the treadmill is running, a short press on the "-" button on the remote control will gradually decrease the speed. A long press will decrease the speed rapidly. The speed will continuously decrease with a decrement of 0.2mph.

Button Description

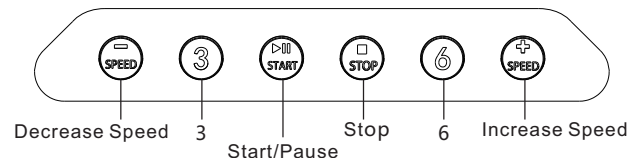

- Function buttons: "Speed-", "3", "Start/Pause", "Stop", "6", "Speed+". Display Metrics Ranges

- "Start/Pause" Button:** In standby mode, press the "I>" button to start the treadmill; in running mode, press the "I>" button to pause the treadmill. (Note: After pausing, the display shows "PAU"; and to resume, a countdown from 3333, 2222, 1111 occurs, returning to the minimum speed.)
 - "SPEED-":** When treadmill is in operation, short press the "-" button on the display for slow deceleration, long press for rapid deceleration, and the speed continuously decreases; the decrement is 0.2mph.
 - "SPEED+":** When treadmill is in operation, short press the "+" button on the display for slow acceleration, long press for rapid acceleration, and the speed continuously increases; the increment is 0.2mph.
 - 3:** Speed shortcut key "3".
 - 6:** Speed shortcut key "6".
- Remote Control Pairing Method**
- When the safety lock is in the detached state, press and hold the "I>" button on the remote control. When you hear continuous beeping sounds from the treadmill buzzer, it indicates successful pairing. You can then start using the remote control to operate the treadmill. Once paired, subsequent usage does not require re-pairing.
- Stop Button:** In running or paused state, press the stop button to end treadmill operation.

Safety Lock Function

Removing the safety lock in any state, the treadmill's display will show error code "E07". When the treadmill is running, removing the safety lock will incur emergency stop. No operations can be performed with the safety lock removed from the treadmill.

Walking and Running Modes

The machine has walking and running modes. In the folded position (column parallel to the treadmill), the treadmill is in the walking mode, with a speed range of 0.6-3.8mph. In the unfolded position, the treadmill is in the running mode, with a speed range of 0.6-7.6mph.



Walking Mode

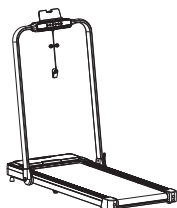

Running Mode

Mobvoi Home intelligent experience

Enhance your treadmill experience by connecting a smartwatch powered by Wear OS by Google™ and installing the Mobvoi Treadmill App on the smartwatch. This allows you to seamlessly track exercise data and monitor your heart rate simultaneously on both your smartwatch and our treadmill.

Download and install Mobvoi Treadmill App

- 1) On the watch platform, open Play Store, search for Mobvoi Treadmill, download and install it.
- 2) On the watch platform, open Play Store, search for Mobvoi Account, download and install it.



Mobvoi Treadmill



Mobvoi Account

- 3) Sign in your Mobvoi account.
 - a. After installing, open the watch platform and Mobvoi Treadmill App. Choose to log in your Mobvoi account with watch or phone.
 - b. If you have not signed in a Mobvoi account, please choose to log in by phone and finish account registration according to tips.

16 Operation Instructions

Experience Mobvoi Treadmill

1. Ensure the treadmill is powered on in Bluetooth mode, and your smartwatch's Bluetooth is activated. Open the Mobvoi Treadmill app on your smartwatch, select "Connect Devices," and witness the automatic pairing between the treadmill and the smartwatch, confirming the successful connection.

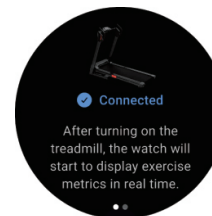

2. Post successful pairing, access heart rate data, exercise records, and real-time information such as exercise duration, speed, distance, calories, and paces directly through the Mobvoi Treadmill App on your smartwatch while exercising.



3. Monitor data during your workout, and maintain a low-speed setting on the treadmill for personal safety.
4. At the end of your exercise session, the smartwatch platform will record and generate a comprehensive sports record.

Experience Mobvoi Health App on Your Phone

Sync your smartwatch data to the Mobvoi Health app on your mobile device for a complete exercise experience.

1. Search for Mobvoi App in the app store, download, and install it. Log in to your Mobvoi account.
2. Navigate to the "Sports Card" on the home page to review your exercise history from the Mobvoi Treadmill app.
3. In the Mobile Mobvoi app, access detailed data records and share your exercise history with others, enhancing your fitness journey.

7. Common Malfunctions and Troubleshooting

If you have any other questions, please contact the local dealer or our company's after-sales service.

Issues	Possible Causes	Troubleshooting Steps
Treadmill cannot operate.	Power not connected.	Plug the power cord into the socket.
	Power not turned on.	Turn the power switch to the ON position.
	Circuit signal system malfunction.	Check the controller input and signal lines.
Running belt does not run smoothly.	Insufficient lubrication.	Apply methyl silicone oil lubricant.
	Running belt too tight.	Adjust the tightness of the running belt.
Treadmill belt slipping.	Running belt slips.	Adjust the tightness of the running belt.
	Loose belt.	Adjust the tightness of the running belt.

Display Error Messages and Solutions

Fault Codes	Possible Causes	Troubleshooting Steps
E01	Communication abnormality between lower control and electronic board.	Check if the communication cable between the lower control and the electronic board is loose or disconnected
E02	1. Motor wires are loose or disconnected. 2. Carbon brushes are worn out or not in contact with the rotor. 3. Lower control is damaged.	Inspect the motor wires for looseness or disconnection. If not disconnected, check if the motor brushes are worn out or not in contact with the rotor. If the motor is normal, the lower control may be damaged.
E05	Overload protection activated.	If there is an overload, exceeding the rated current, turn off the power and restart.
E07	Safety lock not engaged.	Check if the safety lock is not engaged or if the safety lock wire is loose.
E08	Communication abnormality between upper and lower tables.	Check if the communication line connecting the upper table to the lower table is loose or disconnected
Display Abnormalities	External interference.	Turn off the power switch, wait for 1 minute, and then power on and restart.

18 Product Maintenance

8. Product Maintenance

1. Lubrication:

After using the treadmill for a period, it is necessary to lubricate it with the dedicated methyl silicone oil.

Recommendation:

- ★ Weekly usage less than 3 hours Lubricate once every 5 months
- ★ Weekly usage between 4-7 hours Lubricate once every 2 months
- ★ Weekly usage more than 7 hours Lubricate once every 1 month

Remember: Excessive lubrication is not better.

Proper lubrication is a crucial factor in improving the walking pad's lifespan.

2. Checking if Lubrication is Needed:

To check if lubrication is needed, lift the treadmill belt and touch the center of the belt's back with your hand.

If your hand has a slight moist feeling from silicone oil, no lubrication is needed. If the running board is dry and your hand doesn't get any silicone oil, lubrication is required.

- ★ Steps to apply lubricant to the running board (as shown in the right image).
- ★ Stop the walking treadmill running.
- ★ Lift a small portion of the running belt and spray methyl silicone oil on the inner side of the belt, close to the center.
- ★ Run the walking pad at 0.6mph to evenly spread the oil across the running board. Lightly step on the belt from left to right. This process takes a few minutes to ensure complete absorption.

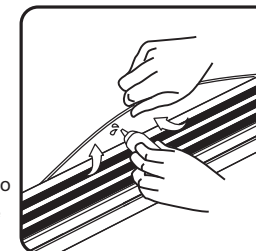

3. Running Belt Tension Adjustment:

All treadmills should be adjusted for running belt tension before out of factory and after setup at home. However, after some usage, the belt may become loose. If users experience a slipping phenomenon while running, the belt needs adjustment. Turn the belt adjustment bolts clockwise, in half-turn increments, synchronously on both sides.

If the treadmill is too loose, when stepping on the running belt, there may be slippage between the running belt and the roller. However, being too tight is not ideal, as it can increase the load on the motor, leading to damage to the motor, running belt, and roller, among other components.

4. Running Belt Deviation Adjustment:

All treadmills should be adjusted for running belt tension before out of factory and after setup at home. However, deviation may still occur after some usage, caused by:

- ① unstable placement;
- ② uneven foot pressure
- ③ uneven force applied by the user with the two feet.

If the running belt is deviated by usage, running without load for a few minutes can restore normal operation. For cases where automatic recovery is not possible, use the provided 6# hex wrench to adjust gradually in half-turn increments.

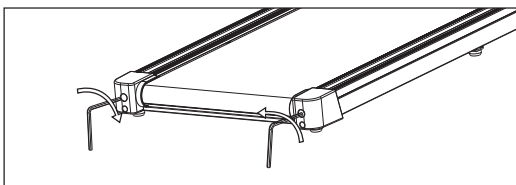

If the belt deviates to the left: Adjust the left bolt clockwise or the right bolt counterclockwise.

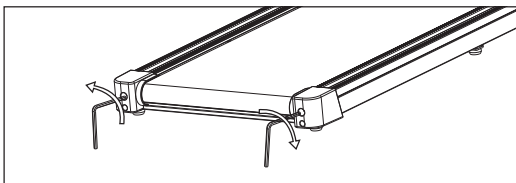

If the belt deviates to the right: Adjust the right bolt clockwise or the left bolt counterclockwise.

Note: Running belt deviation is not covered by the warranty. Users need to perform maintenance according to the instruction manual. Prompt detection and correction are necessary to prevent serious damage.

9. Service Commitment

For the electric treadmill, under normal use within one year, we will provide users with free replacement parts for non-human-induced damages. After the warranty period, spare parts will be provided at favorable prices.

This product is intended for home use only. We are not responsible for issues arising from commercial use. For post-sales issues, contact your local dealer's after-sales service.

20 FCC Statement

We provide statutory warranty service in the country where you purchased the product. Regulatory compliance, full-text Supplier DoC are available on the official website.

Please check out our official website to learn more: www.mobvoi.com/products

Please contact us if you experience any problems. Customer service: support@mobvoi.com

The limited warranty applies for T4225 electric treadmill. Within the warranty period of normal use, such as non-human damage, Mobvoi can provide users with free accessories. After the expiration of the warranty period, preferential prices of spare parts may be offered to previous buyers.

Manufacturer: Jiangxi EQi Industrial Co., Ltd



FCC STATEMENT

This device has been tested. This device should be installed and operated with a minimum distance of 15cm between the antenna and all persons.

This device has been tested and found to comply with the limits for a Class B digital device, pursuant to Part 15 of the FCC Rules. These limits are designed to provide reasonable protection against harmful interference in a residential installation. This device generates, uses and can radiate radio frequency energy and, if not installed and used in accordance with the instructions, may cause harmful interference to radio communications.

However, there is no guarantee that interference will not occur in a particular installation.

If this device does cause harmful interference to radio or television reception, which can be determined by turning the device off and on, the user is encouraged to try to correct the interference by one or more of the following measures:

- Reorient or relocate the receiving antenna.
- Increase the separation between the device and receiver.
- Connect the device into an outlet on a circuit different from that to which the receiver is connected.
- Consult the dealer or an experienced radio/TV technician for help.

Changes or modifications not expressly approved by the party responsible for compliance could void the user's authority to operate the equipment.

This device complies with Part 15 of the FCC Rules. Operation is subject to the following two conditions: (1) this device may not cause harmful interference, and (2) this device must accept any interference received, including interference that may cause undesired operation.